



SOLTAB Flood Lights



One of the most flexible solar fixtures to-date, the SOLTAB features a double-sided solar panel to maximize energy absorption, a radar sensor, constant light output, and a power bank that can be used with portable electronic devices. The LED fixture can be disconnected from the solar panel to allow maximum portability and convenience. The SOLTAB can also be mounted to the wall using the bracket. During installation, the solar panel can be separated from the fixture to accommodate for any urban or residential design. The light features both constant light modes and sensor modes that can be programmed using the buttons located on the light.



For more information, please visit our website:
www.soltechlighting.com

APPLICATIONS

10W SOLTAB Flood Lights

This LED solar flood light is a multifunction work light, as well as a solar energy power bank for your portable electronic devices. SOLTAB combines the best of a flood light and an Eco-friendly power bank.



Power Bank



Flood Light



Sign Light



Camping Light

FEATURES

10W SOLTAB Flood Lights



One Key Control

- Change the operating modes using the silicon rubber on/off button.



User-Friendly

- Tempered-glass laminated, reliable and durable for portable usage. Double-sided solar panel achieves a higher conversion efficiency.
- Tools-free rotator enables solar panel angle adjustment or light direction adjustment, with just bare hands



Multifunctional & Flexible

- The light can be used separately or connected to the solar panel with the water tight quick connector
- Use outdoor as a flood light or wall pack
- Use indoor as a desk light or emergency light
- Use as a portable work light or camping light
- Use as your power bank with solar recharging and a USB port



Ergonomic Design

- Clear Indicator of Battery Capacity: 25% 50% 75% 100%. It quickly shows the battery capacity at any time. Enables better planning for your activities
- Lenses for superior optical control, enhanced lighting efficiency and reduced glare

SOLTAB 10W



DIMENSIONAL DRAWINGS

SOLTAB 10W

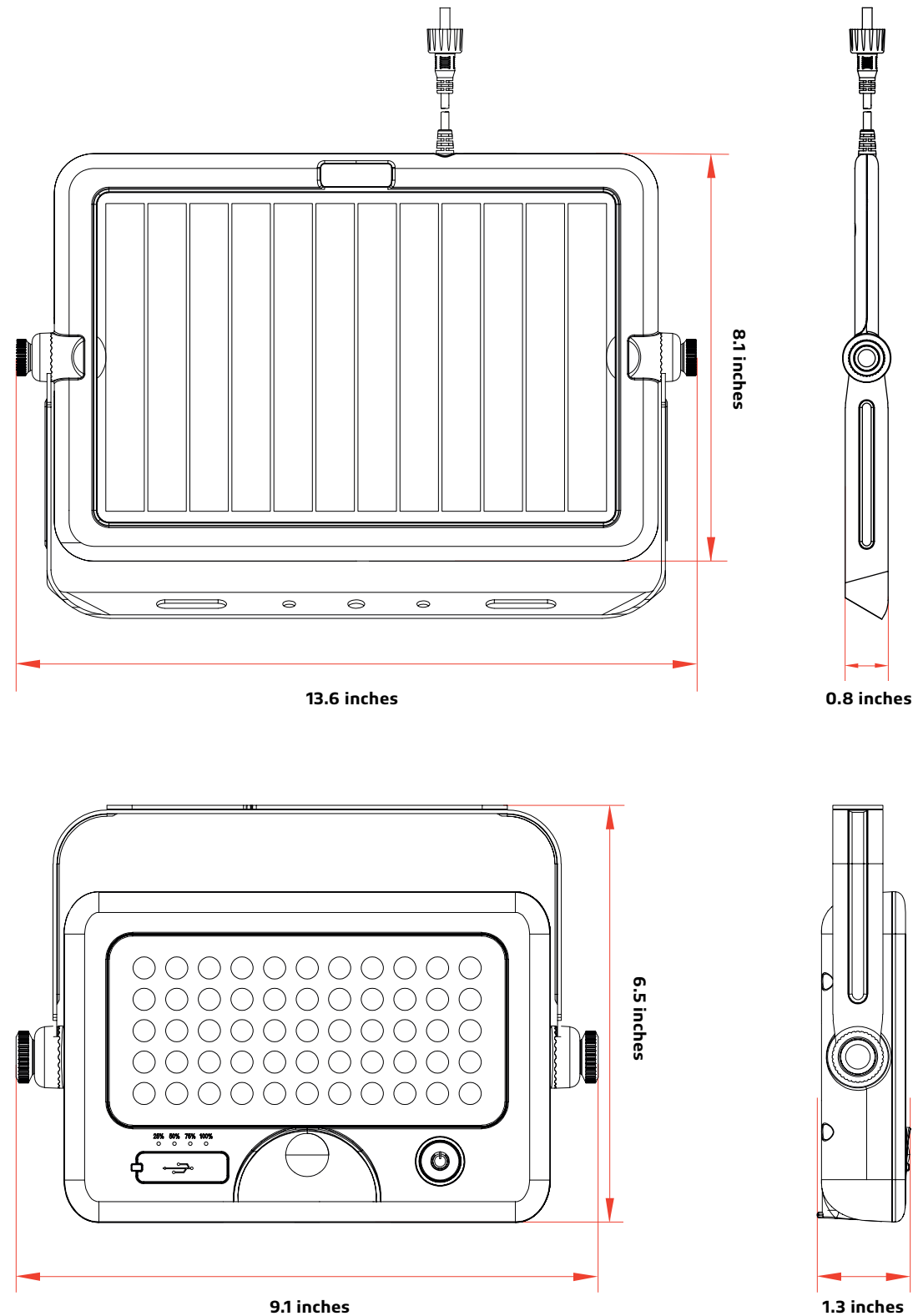

SPECIFICATIONS & PERFORMANCE

10W SOLTAB Flood Lights

One of the most flexible solar fixtures to-date, the SOLTAB features a double-sided solar panel to maximize energy absorption, a radar sensor, constant light output, and a power bank to use with portable electronic devices.



SPECIFICATIONS	SOLTAB 10W
LED NOMINAL POWER	10W
SOLAR PANEL	Mono-Crystalline 6V 10W
LITHIUM ION BATTERY	27WH 3.7V 7.2AH
BEAM ANGLE	90°
LUMEN OUTPUT@4000K	1,100
PRODUCT SIZE	Solar Panel: 13.6 X 8.1 X 0.8 Inches Light: 9.1 X 6.5 X 1.3 Inches
IP RATING	IP65
CRI	CRI > 70
CASTING	PC & ALUMINUM
CABLE LENGTH	9.8 ft
EFFICIENCY@4000K	100 LM/W
PIR SENSOR ANGLE / DISTANCE	90° / 16-26 ft
*CHARGING TIME	7 Hours (1000W/m ²)
RUN TIME	2-3 Days
OPERATION MODE	4 Operating Modes
CCT	4,000K & 5,000K
*OPERATING TEMPERATURE	-5 °F to 113 °F
*CHARGING TEMPERATURE	32 °F to 149 °F

* The temperature can impact the battery's charging and normal operation.
 * The solar charge time data is based on 77 degree F ambient temperature, with the panel pointed directly at the solar radiation. The standard radiation value is 1000W/m².

PHOTOMETRY

SOLTAB 10W

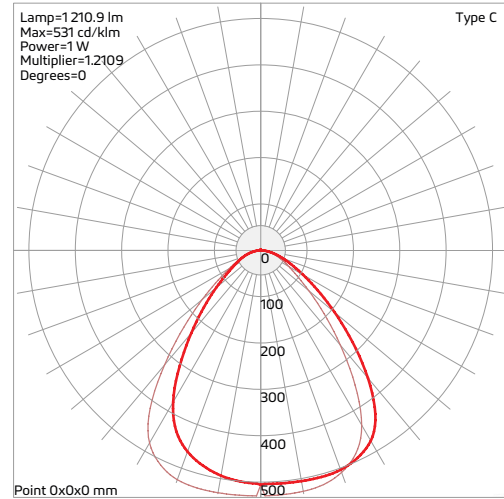

PRODUCT NUMBER BUILDER

Example: STL-TAB104WMBK

This example product number is for SOLTAB 10 watt, 4000K CCT, wall mount installation, with black finish.

SERIES	WATTAGE	COLOR TEMPERATURE	MOUNTING OPTIONS	FINISH
STL-TAB=SOLTAB	10=10W 1000 LUMENS	4=4000K 5=5000K	WM=WALL MOUNT	BK=BLACK

- - - -

Sample Number: STL-TAB10XYZZ

Please **DO NOT** send the generic sample number directly to our salesperson. Use the information in the chart, above, to create a model number with the correct series, wattage, CCT, mounting options, and finish for the product options that you want.

QUICK SHIP PRODUCT



MOUNTING ACCESSORIES (10W)

WALL MOUNT

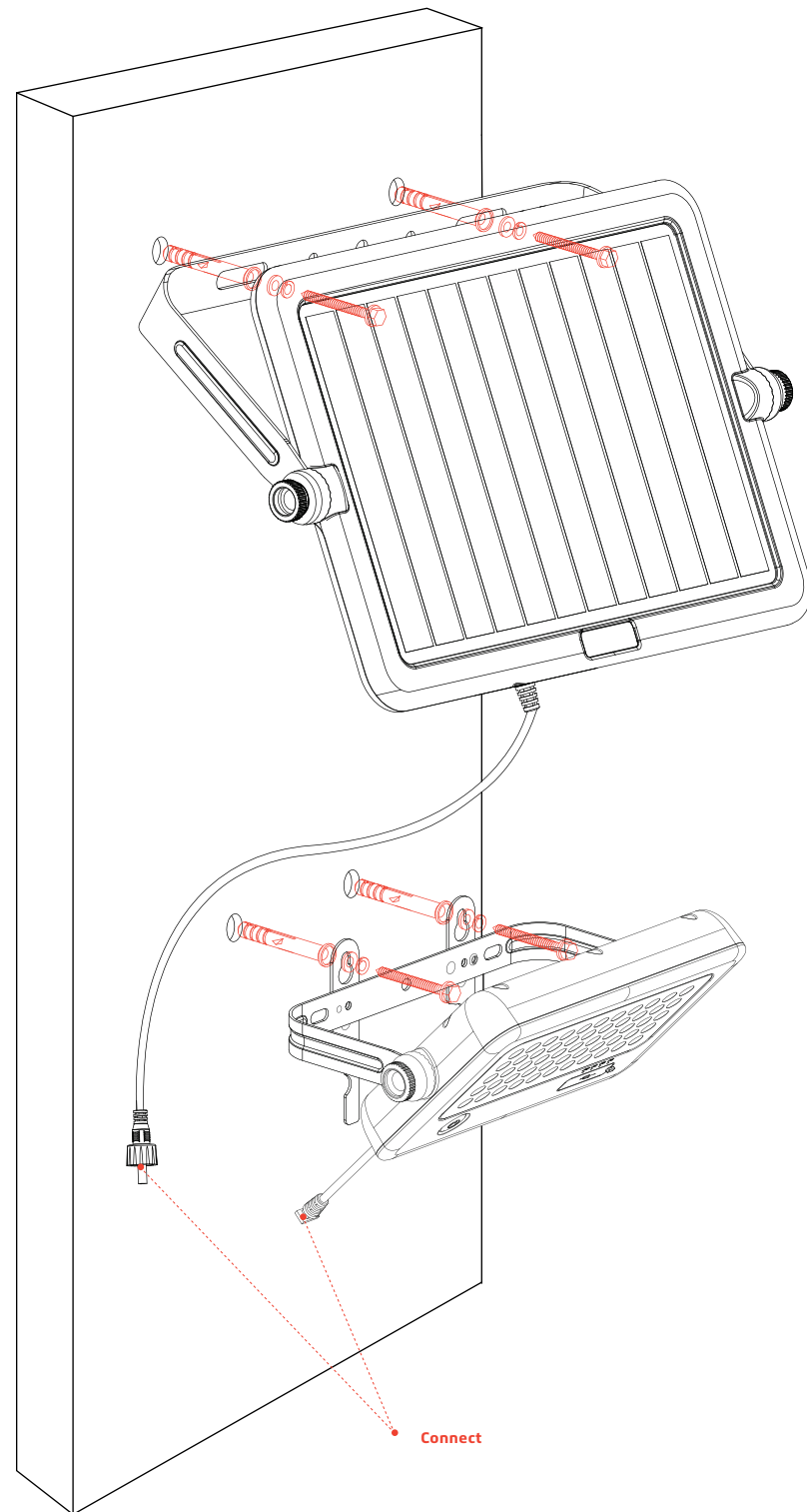

1. Take out all of the parts from the package. Confirm the installation location and wire length.
2. Use the card to mark hole positions, then drill 4 holes of 0.3 inch diameter and 2.4 inches depth.
3. Drive expansion screw into the holes leaving enough room to slide the brackets onto the screws. Then secure the Panel and Fixture.
4. Open the silicon cover at the bottom of the light, connect the cable from the solar panel to the cable from the light and screw together tightly.
5. Adjust the solar panel and LED light to the right angles according to the local latitude and the desired direction for the light.



OPERATING MODES

1. Press 1st time for 50% Constant Brightness.
2. Press for a 2nd time for 100% Constant Brightness.
3. Automatically turns on full brightness (1000lm) when motion is detected within a range of $\leq 8m$ and then turns to 5% brightness after 20 seconds of no motion.
4. Automatically turns on and remain 100% brightness(1000lm) for 5 hours. After 5 hours or when battery capacity < 30% it turns to back to Mode 3.

ADDITIONAL POWER BANK FUNCTION

USB Discharge: 5.0V/1.0A
DC-Micro Charge: 5.0V/1.0A

TIP

In order to get the best lighting results and extend the life span, we suggest you follow the installation guide provided, when you install the light.

